



Phoenix SS1620K / SS1620E Series

FireFox

The Phoenix FireFox SS1620 series is designed and tested to the latest and prestigious European test standards for both Fire and Security Protection.

- **Security Protection** - Tested to the prestigious European S1 Security standard (EN14450 ECB.S Certified)** giving cash cover of £2,000 or Valuables cover of £20,000*
- **Approvals** - Approved by the Association of Insurance Surveyors (AiS).
- **Fire Protection (Paper)** - Tested to the Swedish NT Fire 017 – 120 Paper standard, providing 120 minutes fire protection for paper documents.
- **Fire Protection (Digital Media)** - Tested to DIP120 - 60DM standard providing up to 60 minutes fire protection for DVD, memory stick and hard drives
- **Locking** - Fitted with a high security double bitted VDS class 1 keylock (SS1620K series) or high security VDS class 1 (SECU SELO-A) electronic lock with time delay function (SS1620E series).
- **Drop Test** – Fire and impact tested from 9.1 metres for resistance to the impact of falling through the burning floors of a building.
- **Features** - Internal lockable steel drawer unit in each model. SS1621 & SS1622 supplied with 5 key hooks.
- **Construction** - Double wall construction with high grade concrete infill to provide both fire and burglary protection.
- **Fixing** - Ready prepared for floor fixing, with fixing bolts for concrete supplied.
- **Colour** - Finished in a high quality scratch resistant paint RAL9003 White.



Optional Extras Available
Data Protection Insert
(SS1623K/SS1623E only)

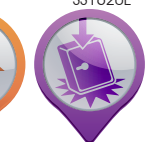

SS1620E

SS1620K

OPTIONAL

*Ratings are approximate only and may vary due to area conditions and location. Please check with your underwriter.

**S1 Security Standard is no longer valid when fingerprint lock only is fitted

Fire strikes without warning! To combat this ever-present threat, Phoenix has provided the ultimate in protection for irreplaceable company records and documents. In a furnace test, with the fire at an incredible 1122°C, the Phoenix Fire Fox safely protected its contents for over 3 hours!

In addition, our engineers have produced not only the finest ever protection against fire, but the cupboard has also been built with security protection in mind. The cupboard has been tested and certified by one of the leading European testing institutions ECB.S to the EN14450 S1 standard.

The safe is locked with a high security double bitting key lock supplied with two keys (SS1620K Series) or user friendly, but high security SECU SELO - A digital electronic Lock (SS1620E Series). This lock allows the user to programme their own personal code of easily remembered numbers. The SS1620 Series also have the advantage of a "slam action" automatic locking mechanism for emergency use.

The large capacity of the SS1620 Series with internal capacities from 129 litres to 315 litres provide ample storage for irreplaceable documents and valuables. Each unit is also fitted with adjustable full width shelves and one lockable steel drawer unit.

File Capacity Chart

| Type of document file | Total number of files per unit | Configuration | Total number of files per unit | Configuration | Total number of files per unit | Configuration |
|---|--------------------------------|--|--------------------------------|---|--------------------------------|---|
| Series: SS1620 | Model: SS1621 | | Model: SS1622 | | Model: SS1623 | |
| A4 Lever Arch Folder (H320 x W75 x D290mm) | 9 | 1 rows of 6 files 3 files on side at top of unit | 12 | 2 rows of 6 files | 21 | 3 rows of 7 files |
| Foolscap Lever Arch Folder (H350 x W80 x D285 mm) | 8 | 1 row of 5 files 3 files on side on top shelf | 10 | 2 rows of 5 files | 18 | 2 rows of 7 files 4 files on side on top shelf |
| Foolscap Box File (H370 x W75 x D245mm) | 9 | 1 row of 6 files 3 files on side on top shelf | 13 | 2 rows of 6 files 1 file on side on top shelf | 17 | 2 rows of 7 files 3 files on side on top shelf |



DEALER'S STAMP

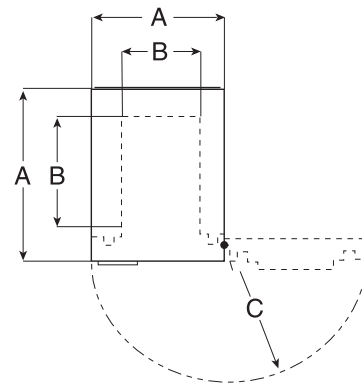

● Dimensions stated as:

- A External height x width x depth
- B Internal height x width x depth
- C Door swing / Door Handle Depth
- D Weight
- E Capacity
- F No of drawers, No of shelves
- H Internal Key Hooks

● FireFox SS1621K/SS1621E

- A 960mm x 655mm x 557mm
- B 780mm* x 475mm x 348mm
- C 600/50mm
- D 188 kgs
- E 129 ltr
- F 1 Drawer, 2 Shelves
- H 5

● FireFox SS1622K/SS1622E

- A 1160mm x 655mm x 560mm
- B 980mm* x 475mm x 350mm
- C 600/50mm
- D 228 kgs
- E 162 ltr
- F 1 Drawer, 2 Shelves
- H 5

● FireFox SS1623K/SS1623E

- A 1385mm x 775mm x 650mm
- B 1205mm* x 595mm x 440mm
- C 720/50mm
- D 348 kgs
- E 315 ltr
- F 1 Drawer, 3 Shelves
- H 0

● Data Protection Insert – FSDPI03 (SS1623K/SS1623E only)

- A 301mm x 518mm x 357mm
- B 170mm x 366mm x 230mm
- D 20 kgs

*The drawer reduces the internal height by 105mm

All weights and sizes are approximate.

Phoenix policy is one of constant improvement. We therefore reserve the right to alter any part of the specification achieved in this publication without incurring any obligation.



Certificate Number 1059
ISO 9001

SS1620 / 12 14 GB